

- 1
- 2
- 3
- 4
- 5
- 6
- 7
- 8
- 9
- 10
- 11
- 12
- 13
- 14
- 15
- 16
- 17
- 18

MATERIAL

Polyamide based (PA) technopolymer, black colour, matte finish.

STANDARD EXECUTIONS

- **BT-AV-B**: brass boss, threaded blind hole.
- **BT-AV-p**: zinc-plated steel threaded stud, chamfered flat end according to UNI EN ISO 4753:2012 (see Technical data on page A-11).

FEATURES AND APPLICATIONS

The cable in the upper part is an ideal support when you have to tighten with a 6.5 mm flat-blade screwdriver.



ELESA Original design

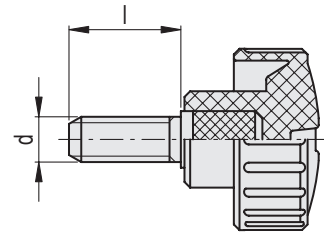
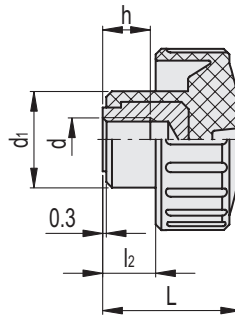
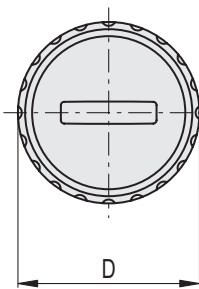

Conversion Table	
1 mm = 0,039 inch	
D	
mm	inch
12	0,47
16	0,63

BT-AV-B

METRIC

Code	Description	D	d6H	L	d1	l2	h	△
7310	BT.12 AV-B-M3	12	M3	12	9.5	4	6	5
7311	BT.12 AV-B-M4	12	M4	12	9.5	4	6	4
7312	BT.12 AV-B-M5	12	M5	12	9.5	4	6	3
7320	BT.16 AV-B-M3	16	M3	13.5	11	5	6	6
7321	BT.16 AV-B-M4	16	M4	13.5	11	5	6	5
7322	BT.16 AV-B-M5	16	M5	13.5	11	5	6	4

BT-AV-p

METRIC

Code	Description	D	d6g	L	d1	l	l2	△
7337	BT.12 AV-p-M3x6	12	M3	12	9.5	6	4	2
7338	BT.12 AV-p-M3x10	12	M3	12	9.5	10	4	2
7340	BT.12 AV-p-M4x6	12	M4	12	9.5	6	4	2
7341	BT.12 AV-p-M4x10	12	M4	12	9.5	10	4	3
7343	BT.12 AV-p-M5x10	12	M5	12	9.5	10	4	4
7344	BT.12 AV-p-M5x16	12	M5	12	9.5	16	4	4
7347	BT.16 AV-p-M3x6	16	M3	13.5	11	6	5	2
7348	BT.16 AV-p-M3x10	16	M3	13.5	11	10	5	2
7350	BT.16 AV-p-M4x6	16	M4	13.5	11	6	5	2
7351	BT.16 AV-p-M4x10	16	M4	13.5	11	10	5	3
7356	BT.16 AV-p-M4x16	16	M4	13.5	11	16	5	3
7371	BT.16 AV-p-M5x10	16	M5	13.5	11	10	5	6
7376	BT.16 AV-p-M5x16	16	M5	13.5	11	16	5	7